

# **Deluxe Z**

## **Construction Guide**

**June 2003**

**© Copyright – All Rights Reserved.**

# TYPICAL SLAB & PAD FOOTING DETAIL

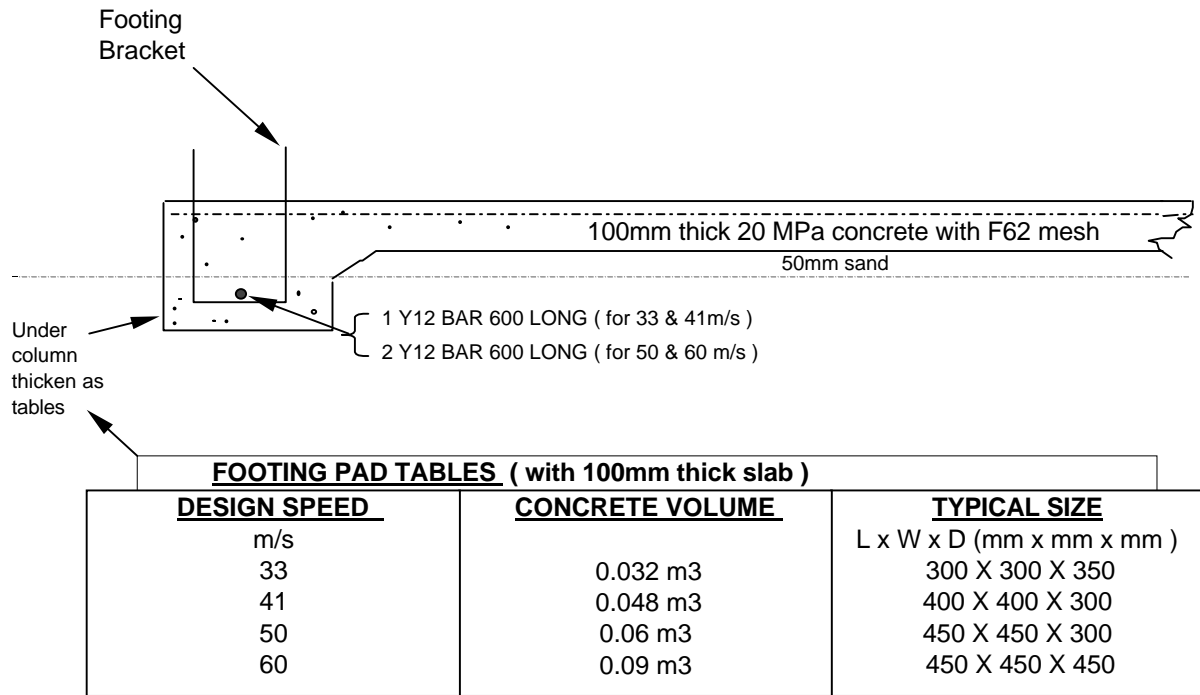

Applicable to all Engineering Drawings up to 7.5 metres wide

## Typical heavy Industrial Slabs

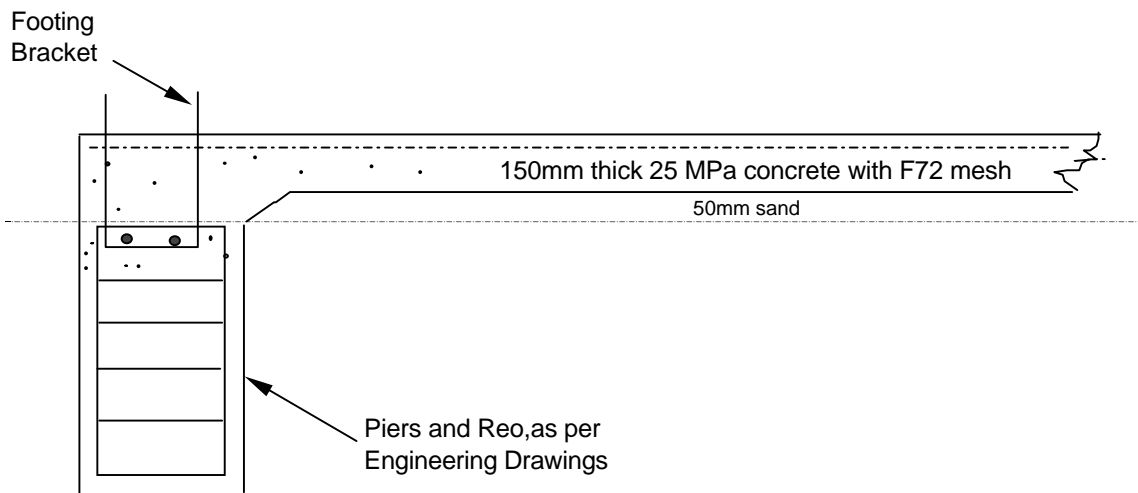

# FOOTING BRACKET DETAIL

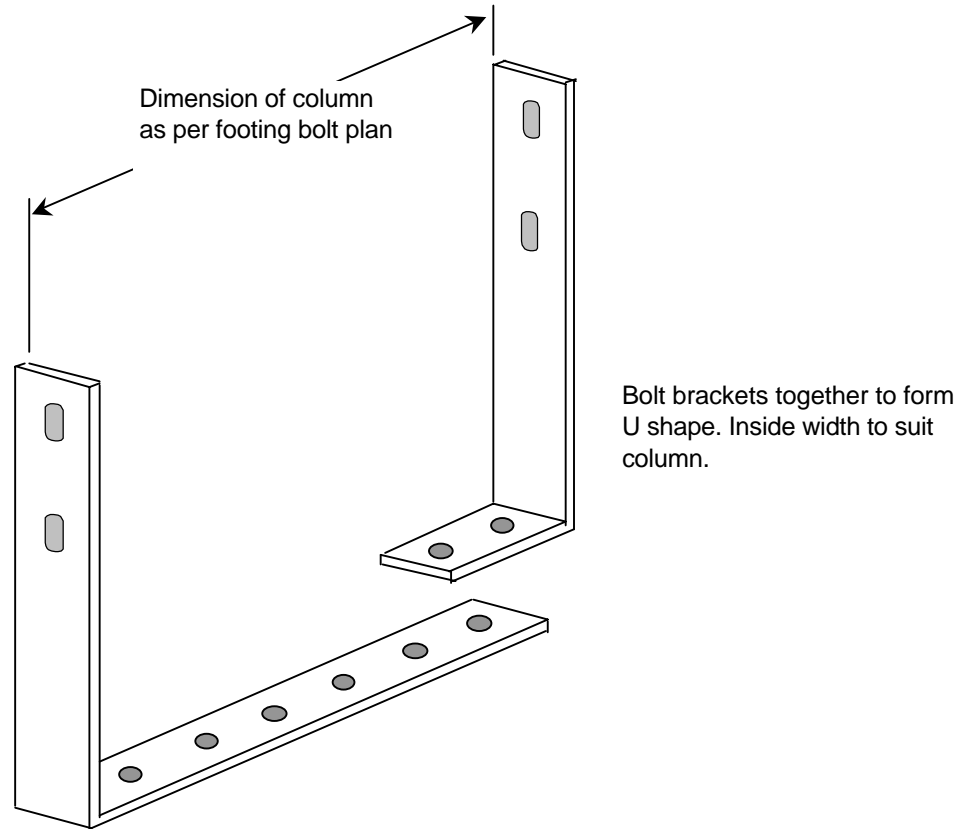

# FOOTING BRACKET DETAIL

## BHP Sections

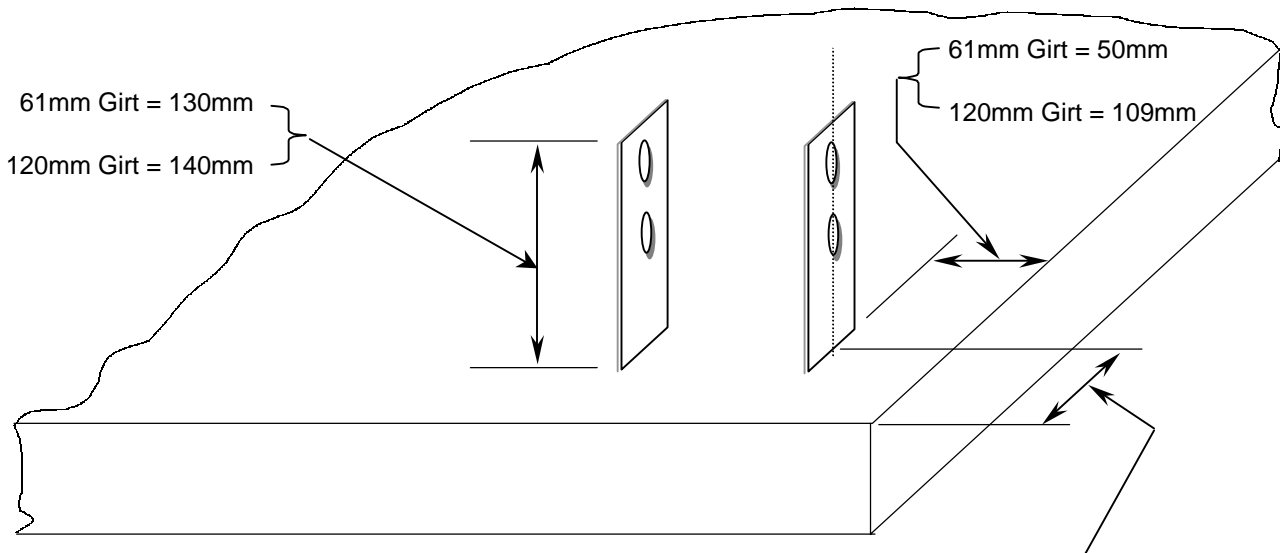

### BHP Sections

Domestic Range up to 7.5m wide use 61mm girts  
 Industrial Range greater than 7.5 wide use 120mm girts

C-Section	Domestic	Industrial
100	81	
150	88	147
200	94	153
250	94	153
300		163
350		177

**In concrete footing bracket detail  
33, 41 & 50 M/S buildings**

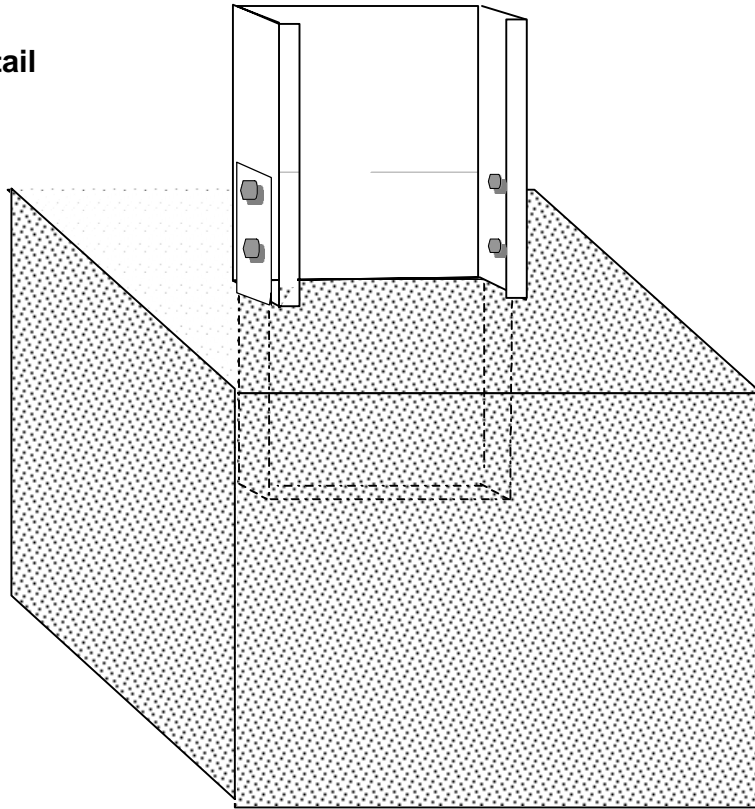

Portal Column

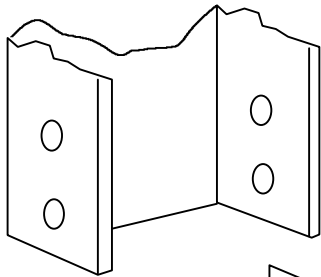

Footing Bracket

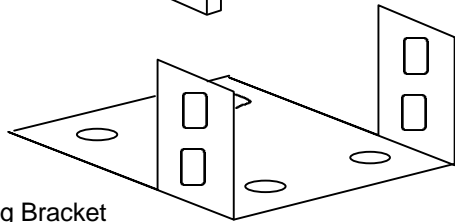

**On slab footing bracket detail  
33 & 41 M/S only buildings**

**For footing spacings  
refer to footing bolt plan**

Clear and level the site, a Bobcat with auger is recommended. Mark out the building using ( Bay Spacing and Portal Frame ) details for your particular building. Mark the column positions with specifications from the Engineering drawing, have the Bobcat drill pier holes using the correct size auger, to the depths specified.

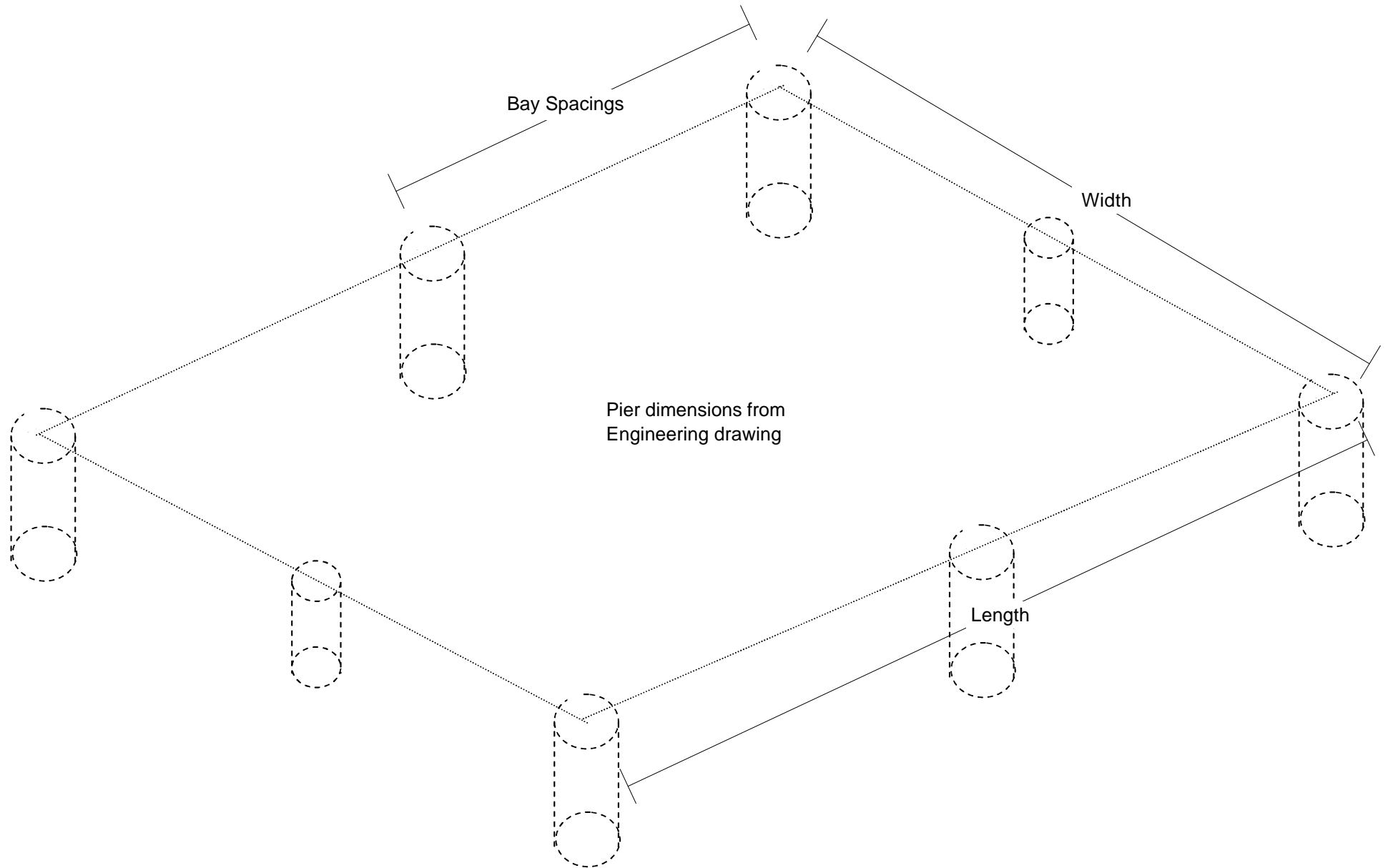





Assemble one portal frame to the correct dimensions and use as a pattern.  
Lay each portal frame on the pattern in turn to assemble identically.  
Be sure to use the correct amount of M14 locking Tek screws before moving each portal frame.

### Apex Detail

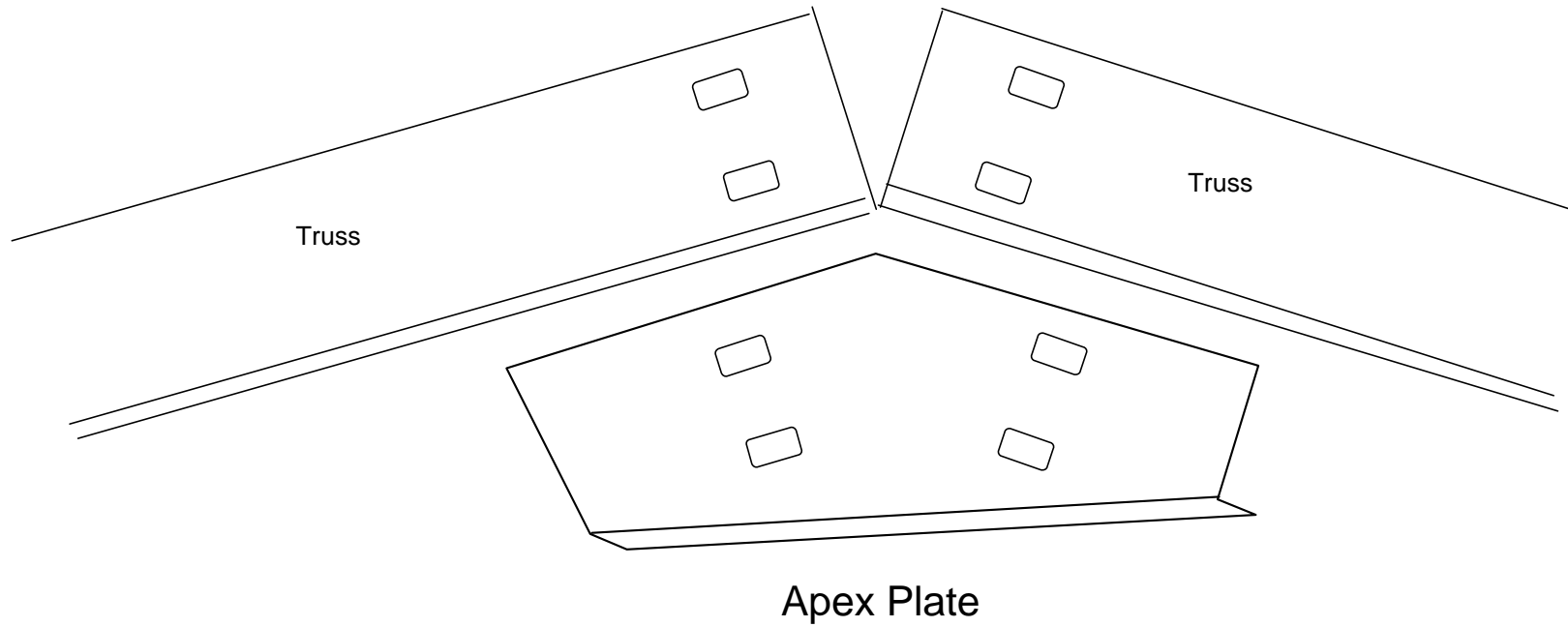

Stand portal frames and brace with top hats  
check all dimensions and be sure to have all  
frames plumb, level and square before pouring  
concrete into pier holes,  
Once concrete is set remove bracing and  
continue with construction. Reffer to the  
Engineering drawing for all dimensions.

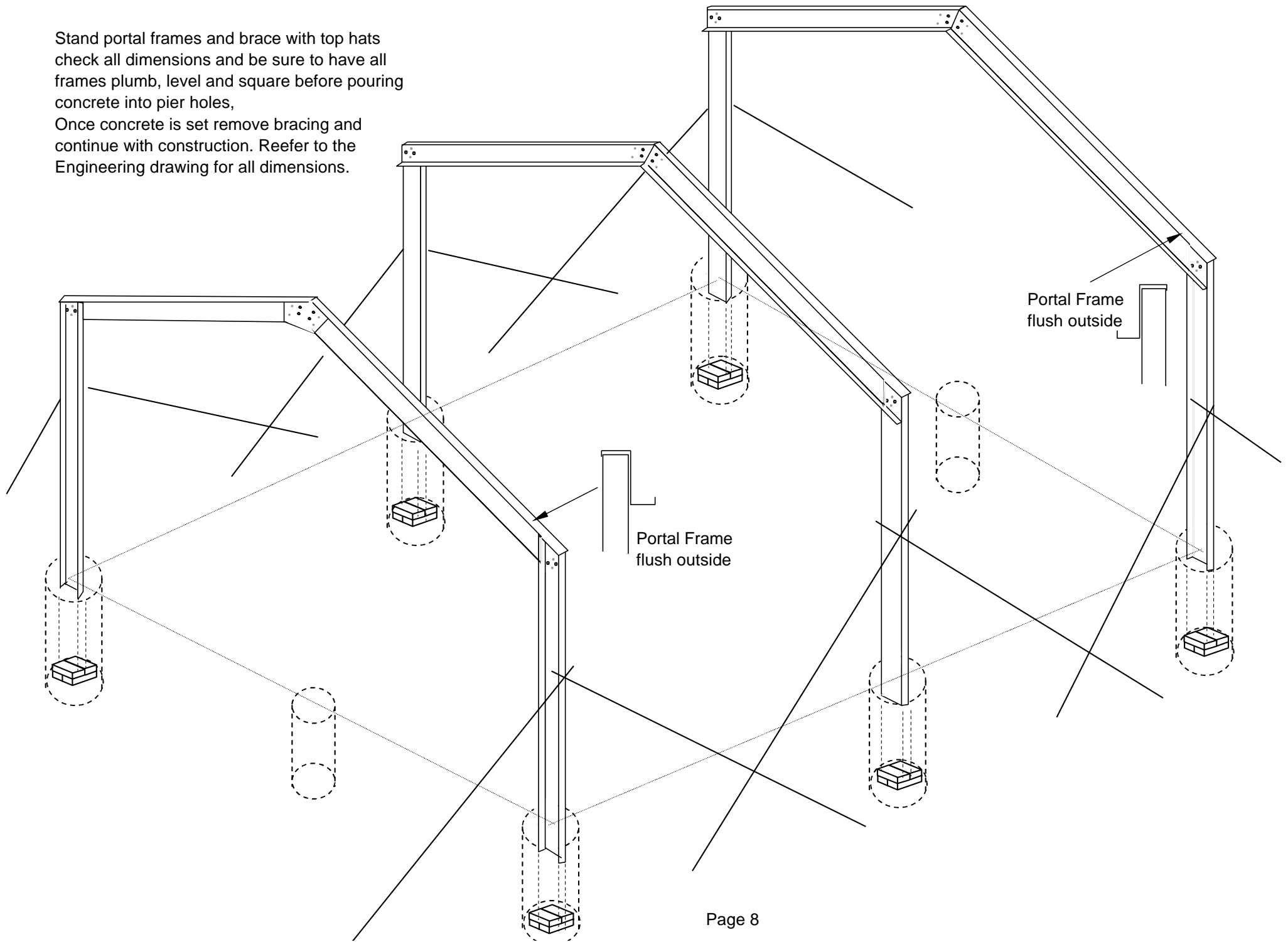

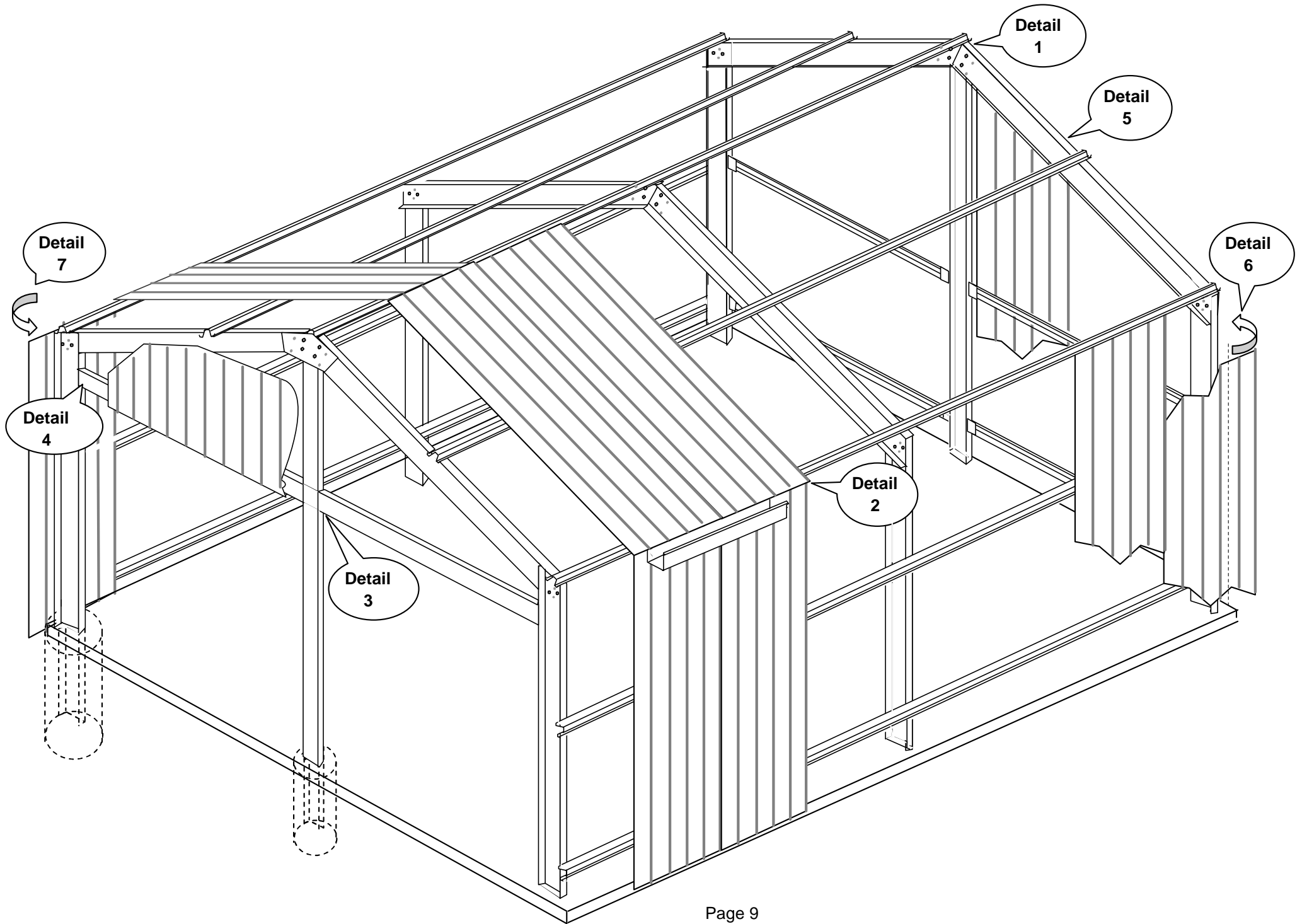

**Detail 1**

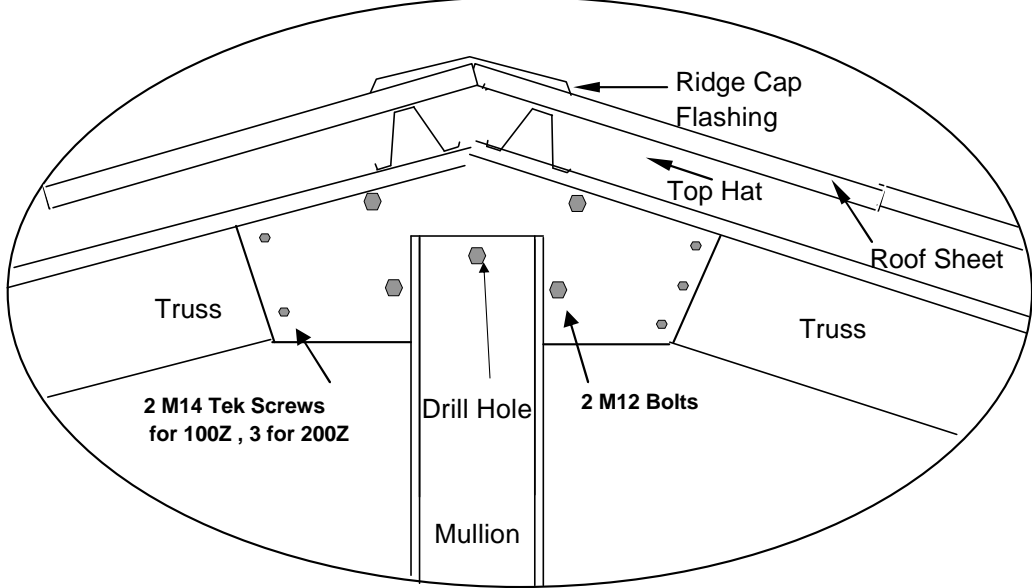

**Detail 2**

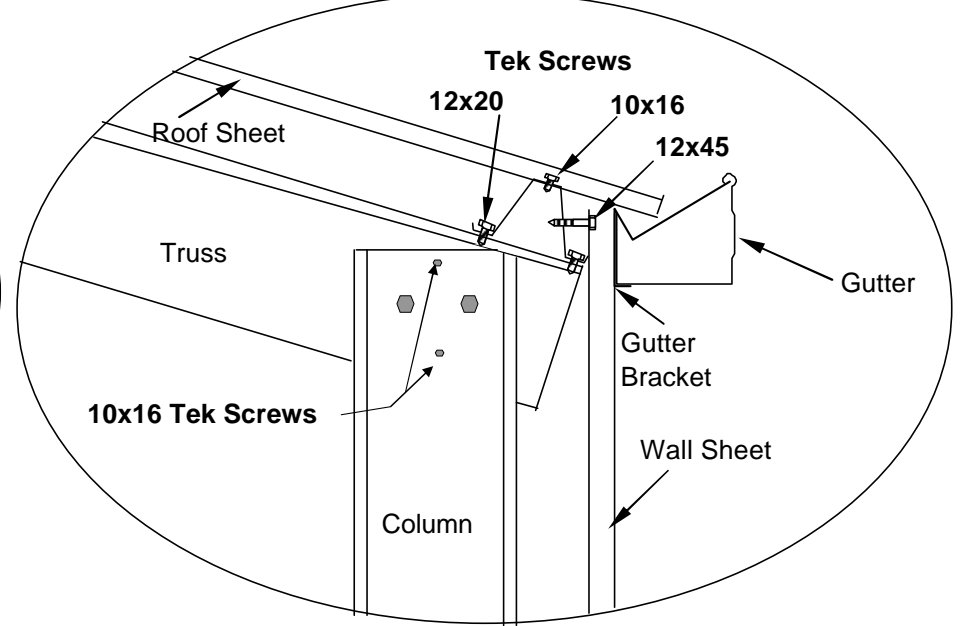

**Detail 3**

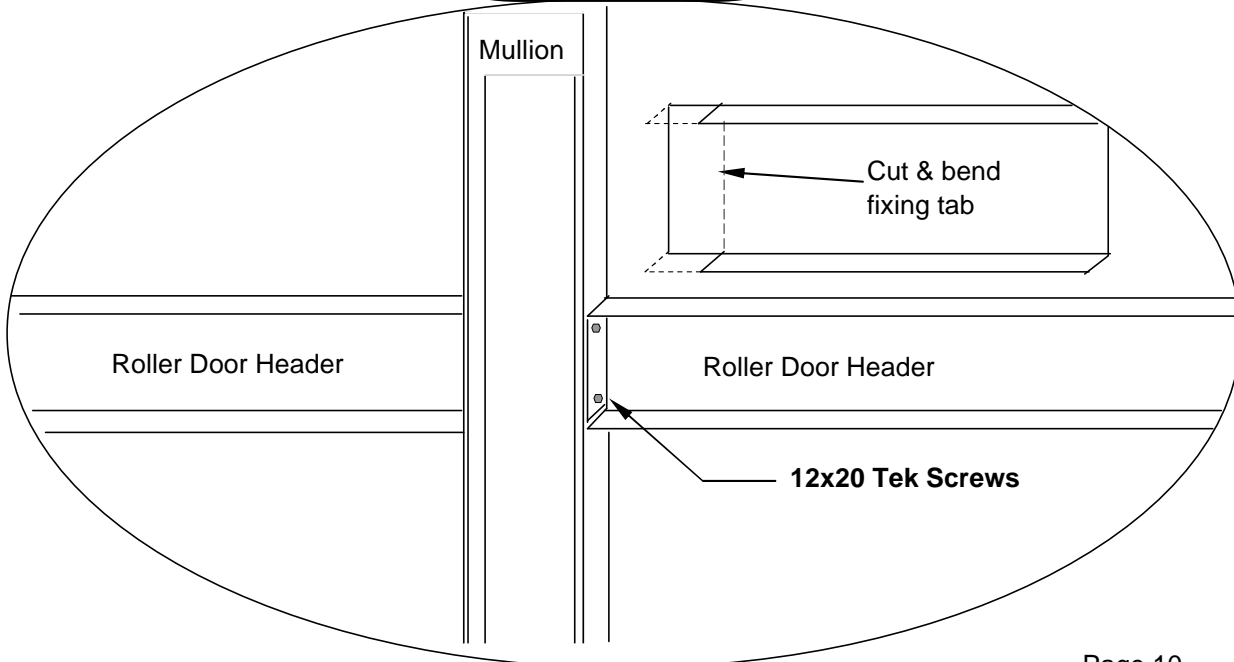

**Detail 4**

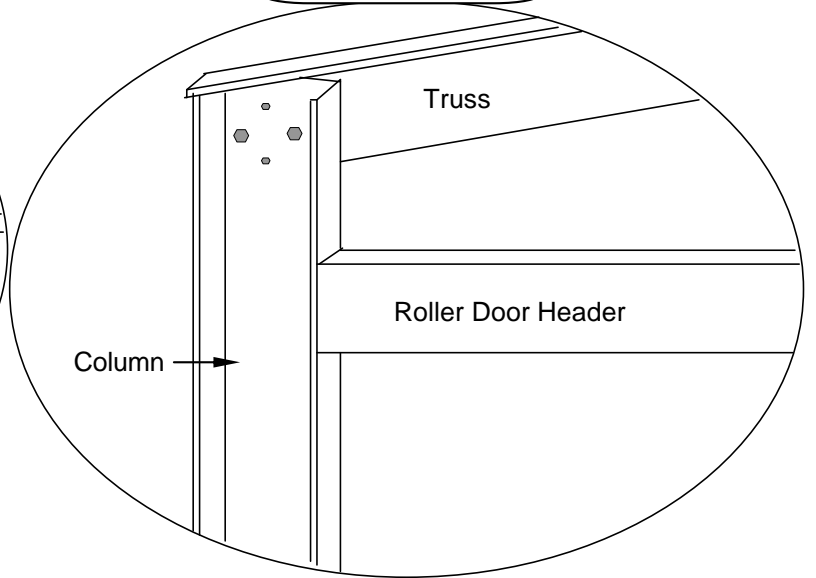

**Detail 5**

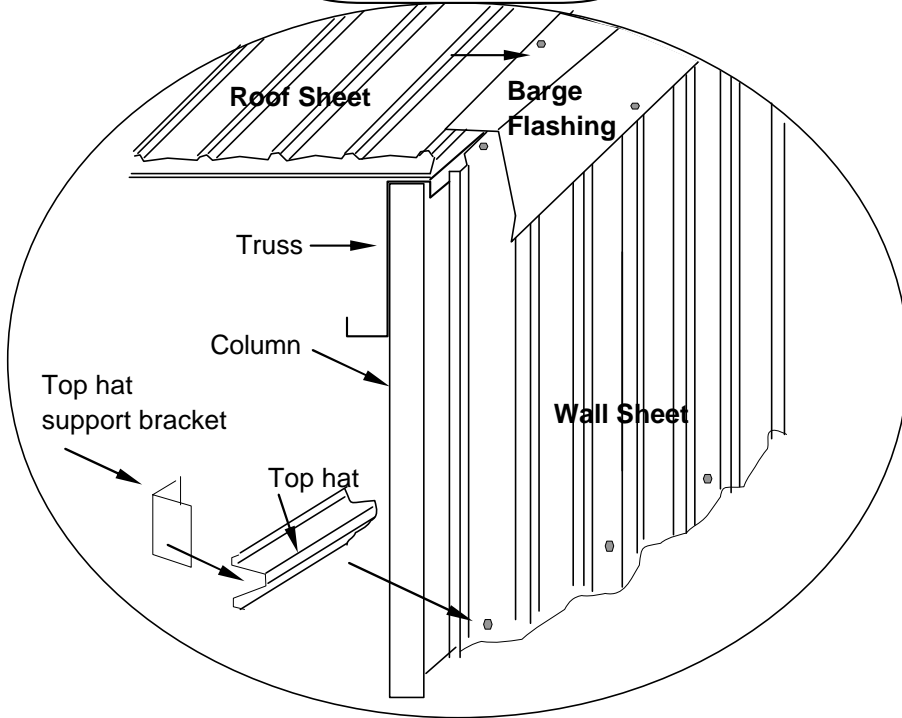

**Detail 6**

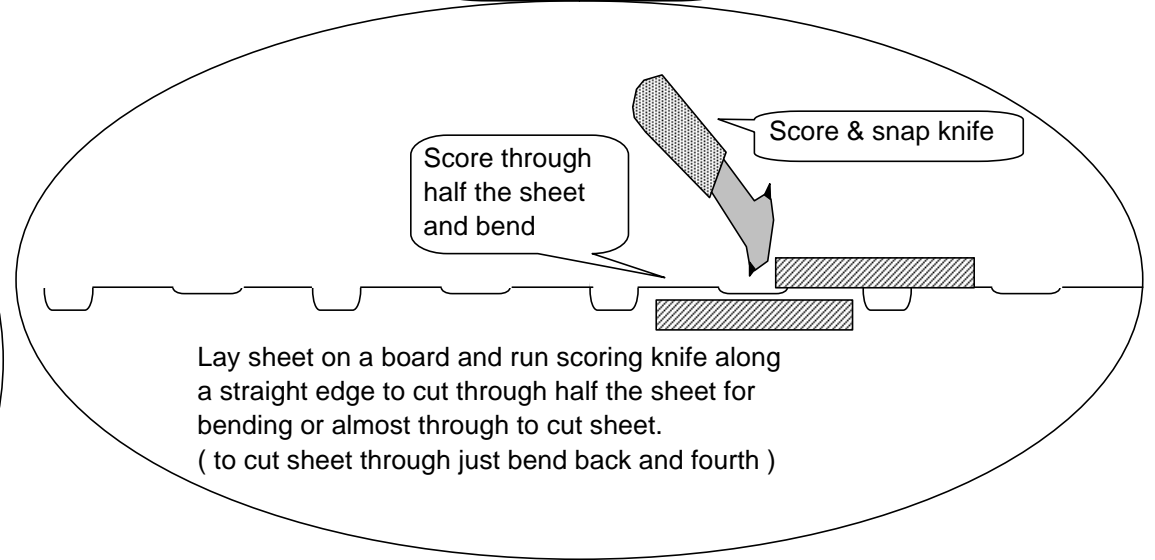

**Detail 7**

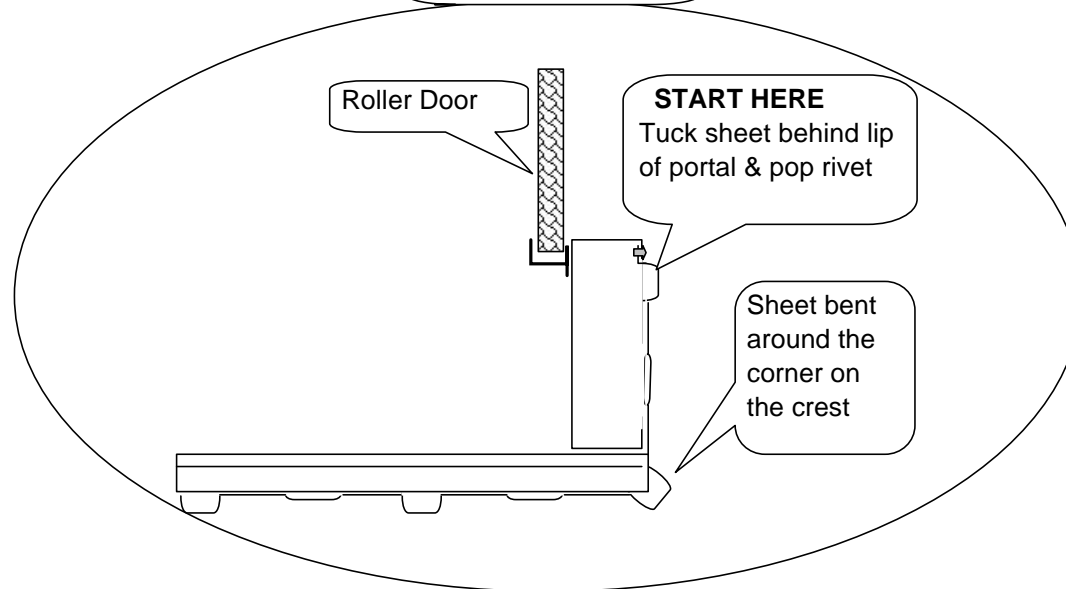

# RIDGE CAP DETAIL

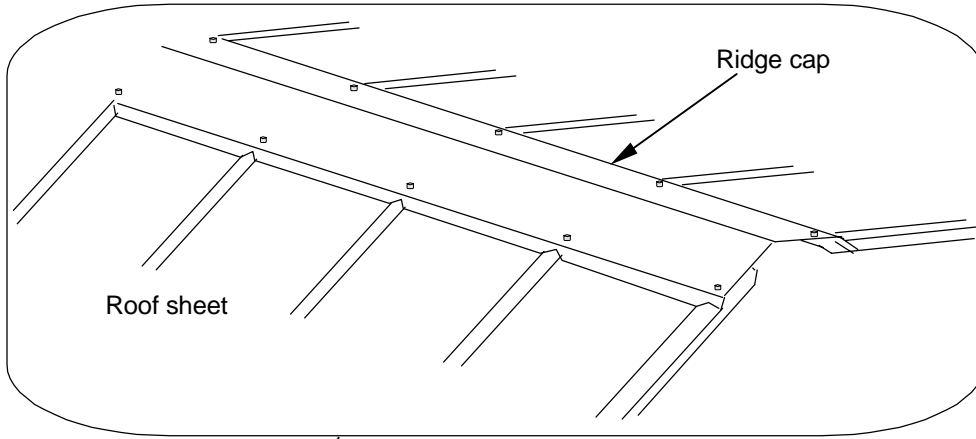

1. Bend end of roof sheets
2. Screw roof sheets to top hats except at ridge
3. Position ridge capping on ridge line
4. Scribe crest of roof sheeting on ridging and cut with tin snips to allow ridging to sit in pan of roof sheeting
5. Screw ridge with 12 x 45 tek through crest of sheeting into top hat batten

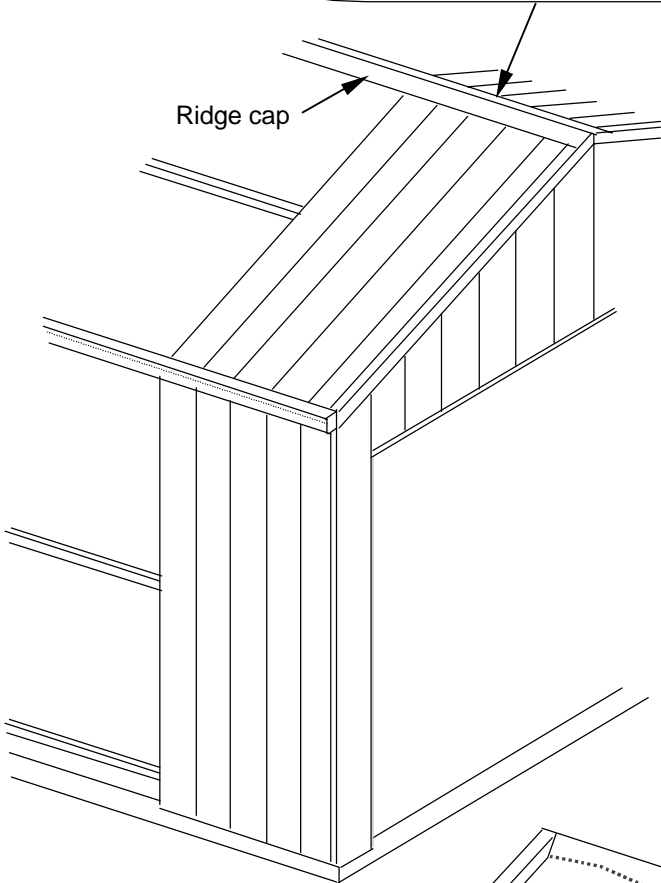

A piece of 75 x 30 timber with a saw cut in the end will do as a pan bending tool

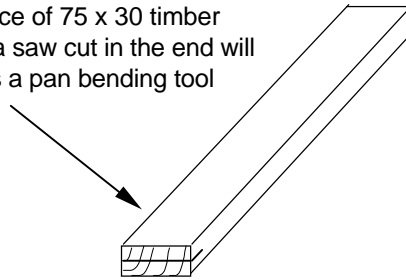

Bend roof sheeting pan upwards to prevent water blowing under ridge and into shed.

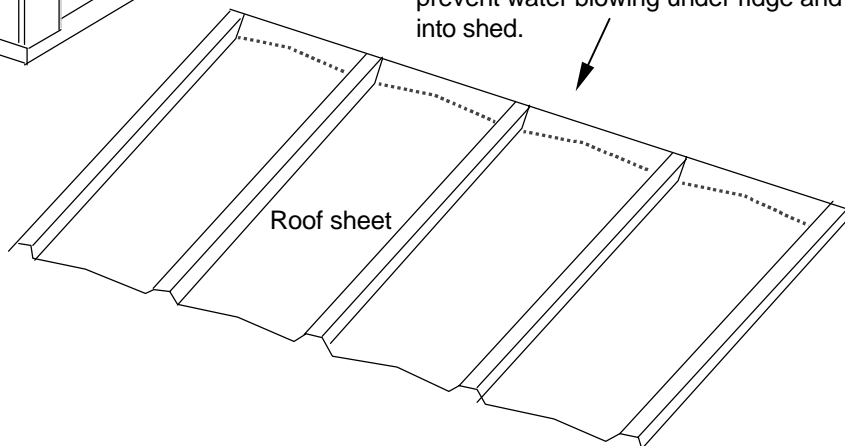

# DOWNPIPE & FRONT FLASHING DETAIL

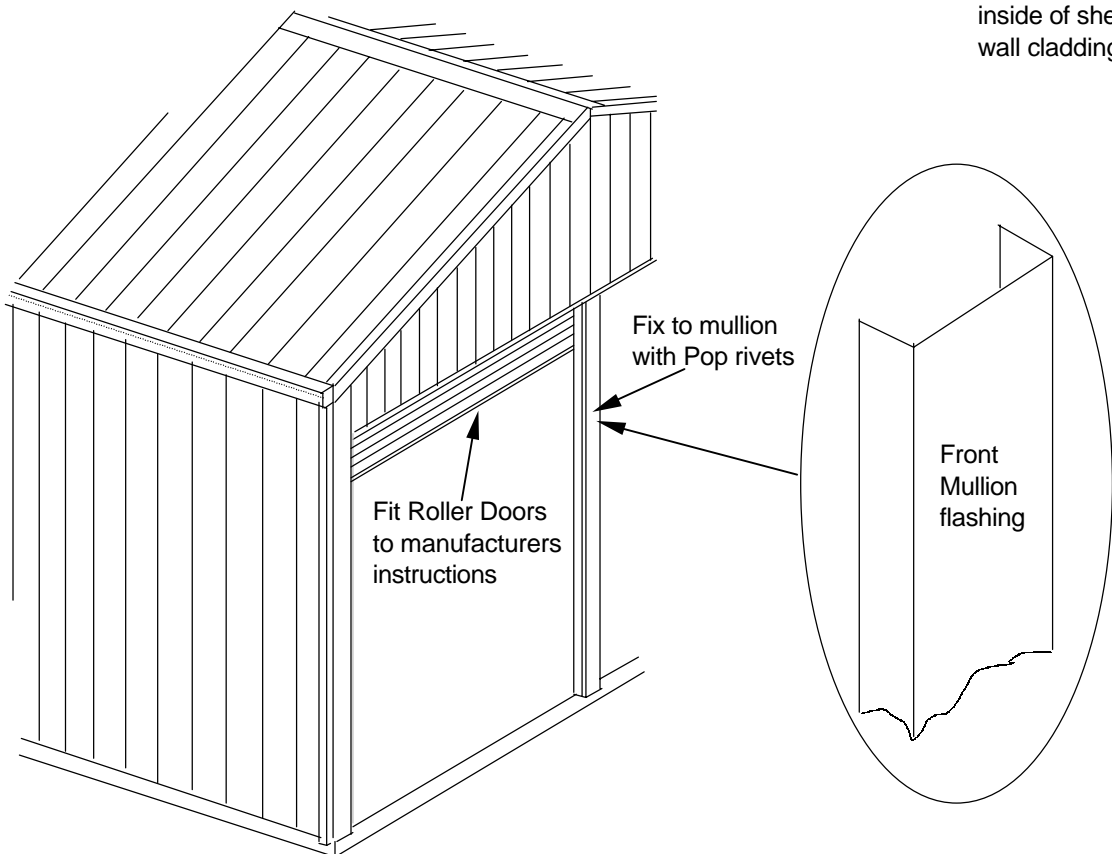
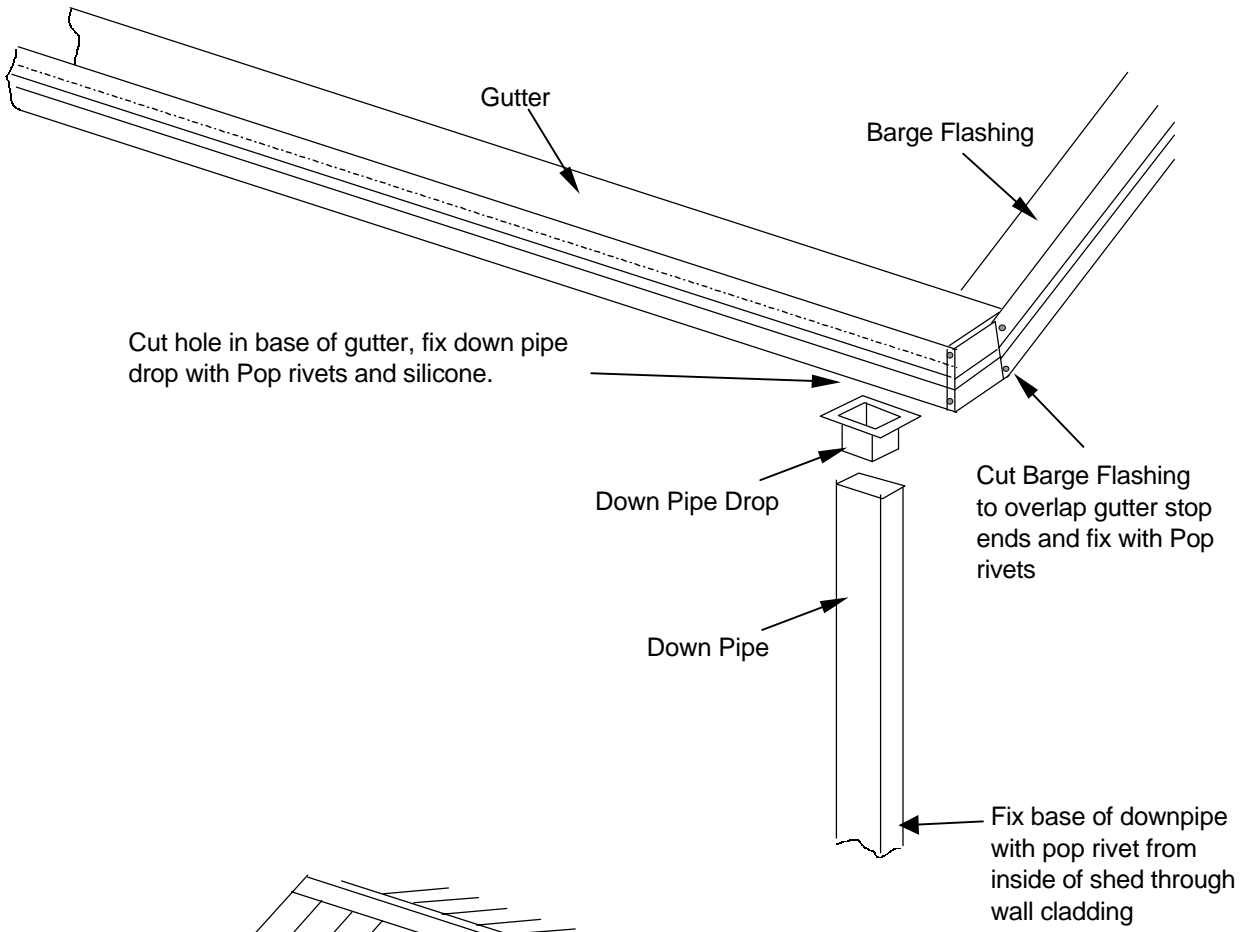



# WINDOW JAMB DETAIL

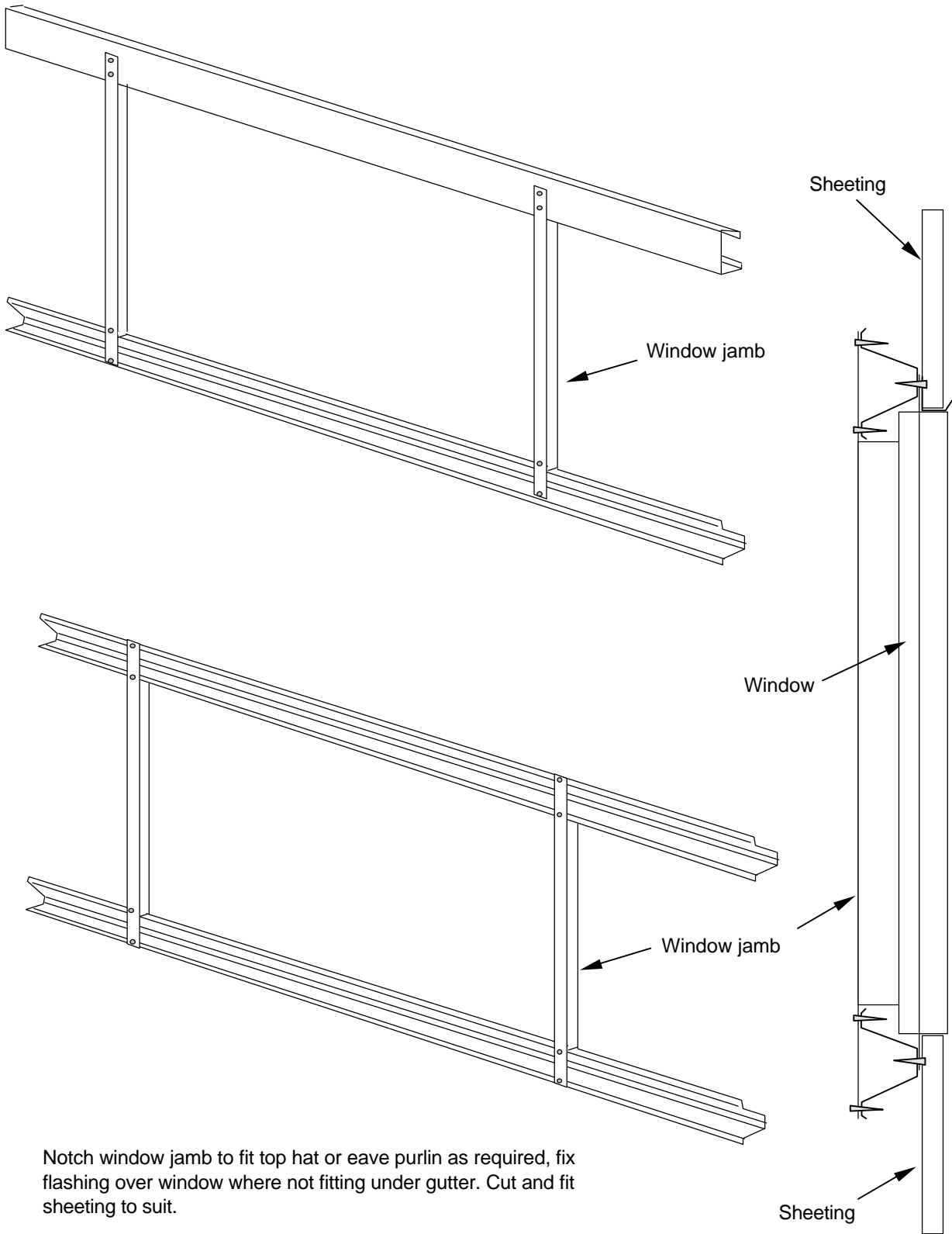

Notch window jamb to fit top hat or eave purlin as required, fix flashing over window where not fitting under gutter. Cut and fit sheeting to suit.

# PA Door Jamb Detail

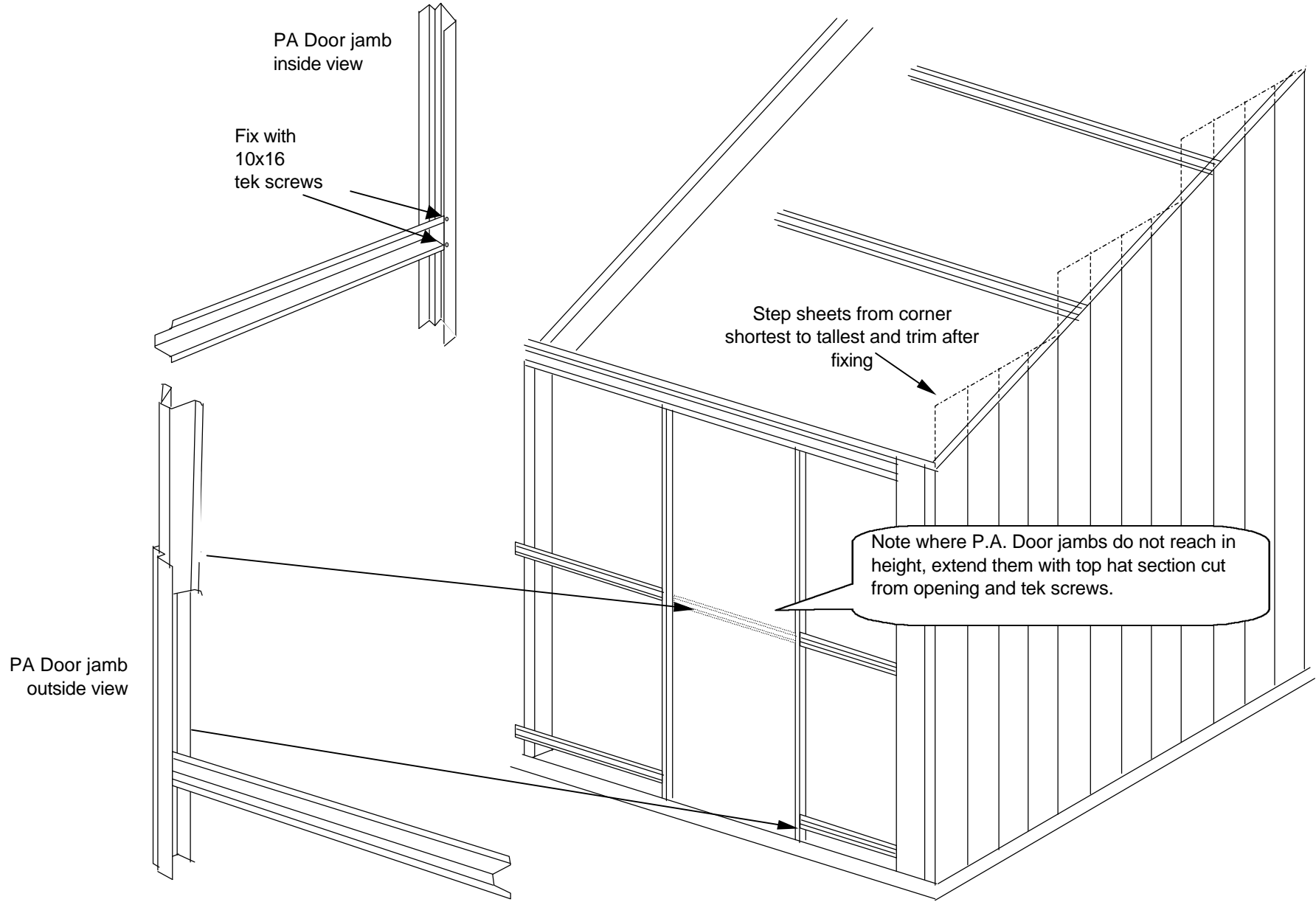

# DOMESTIC PA DOOR (PRESSED METAL)

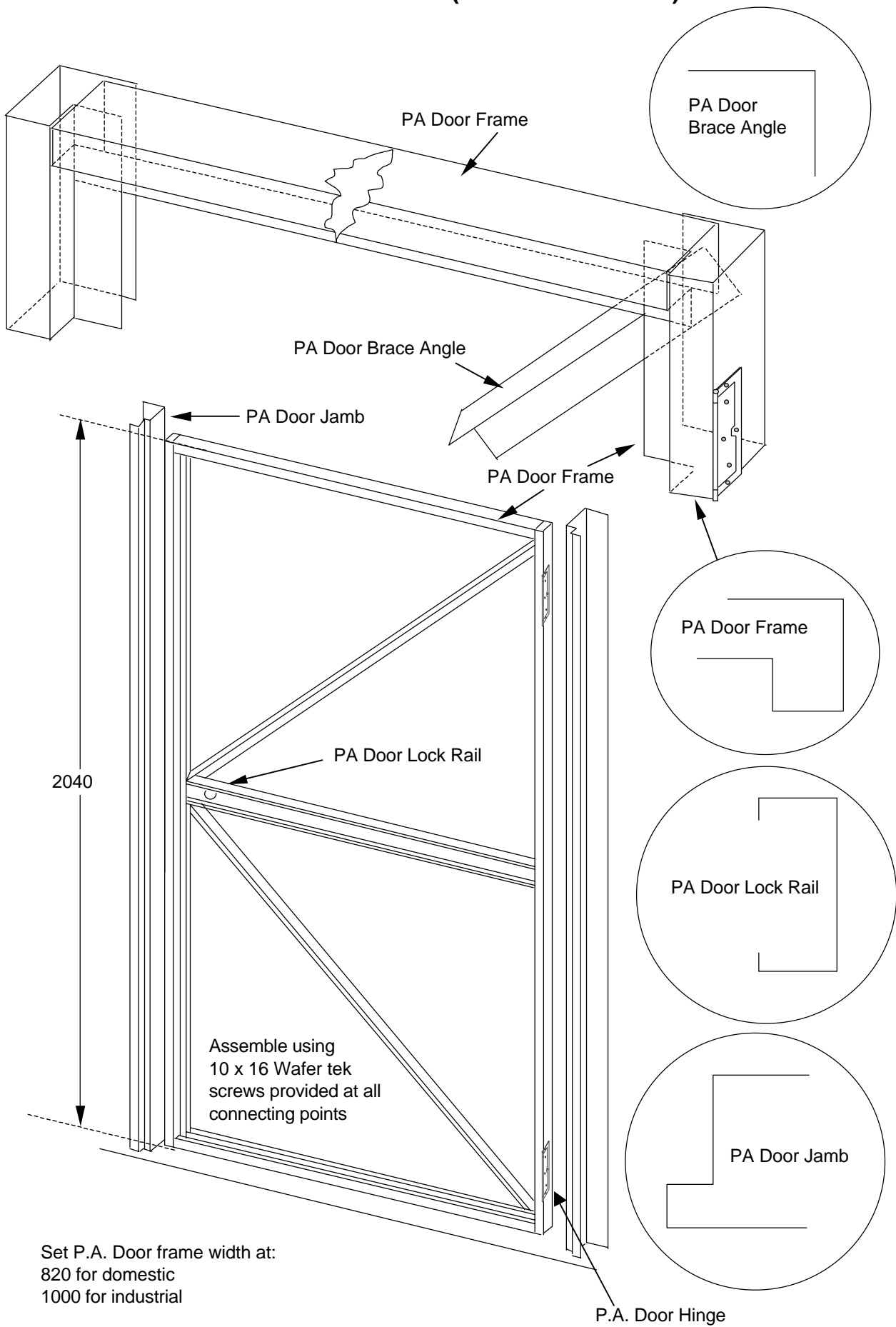

# DOMESTIC PA DOOR (SHS COLUMN)

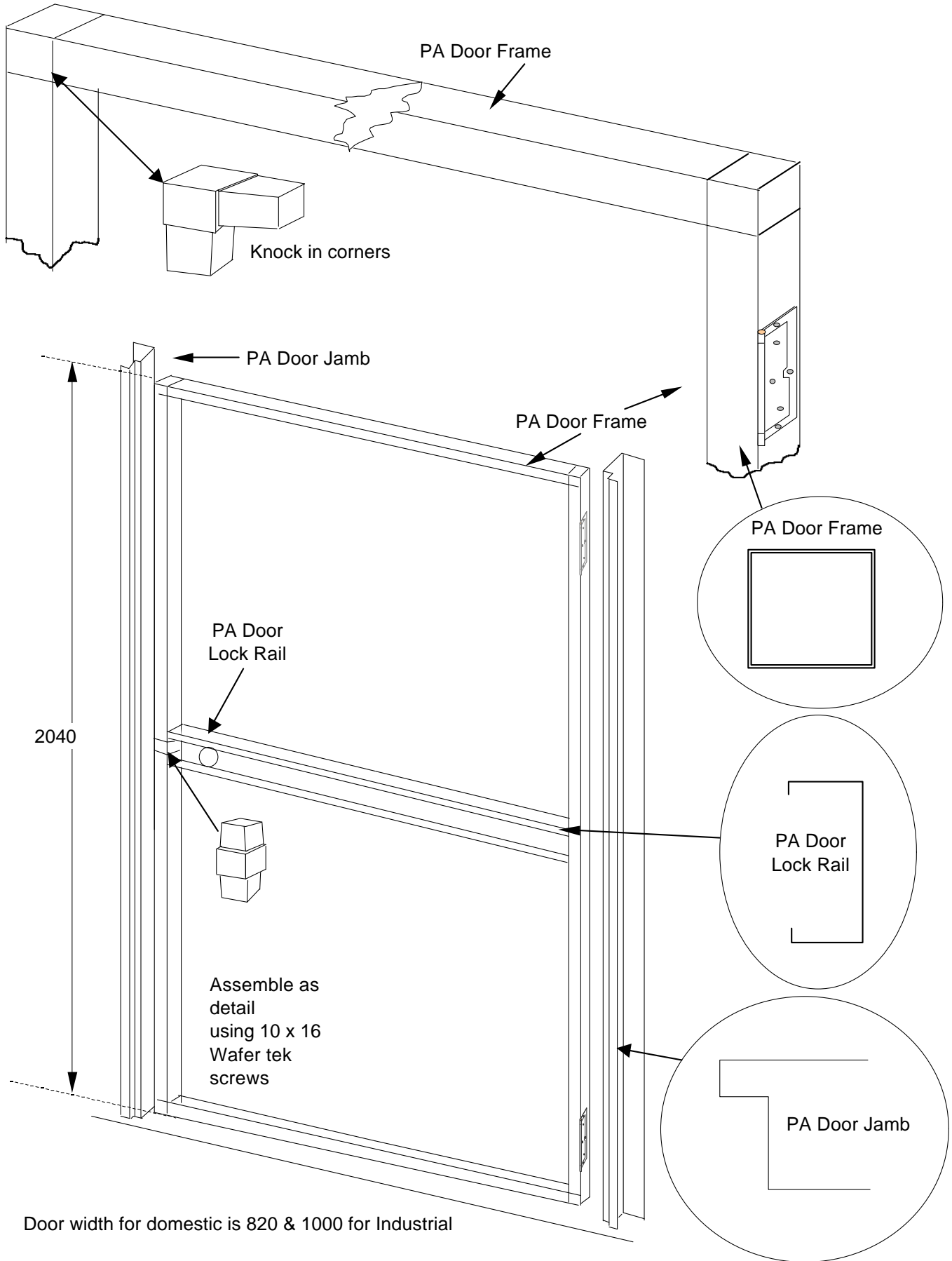

Door width for domestic is 820 & 1000 for Industrial

# COMPONENTRY IDENTIFICATION LIST

Monoclad, Monowall,  
Trimwall, Trimdek,  
Fibreglass



Corrugated Iron,  
Fibreglass



K-Panel, Multiclad



Rectangular Downpipe  
Drop



Rectangular Downpipe

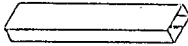

Round Downpipe Drop



Round Downpipe

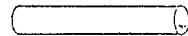

Top Hat

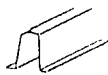

Kwikspan Bolt



Dynabolt



Pop Rivet

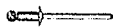

Frame Apex Plates  
Screw (14 x 10 x 20)



Screw For Fixing  
Top Hats (12 x 20)



Tek Screw (Roof)  
With Neo Washer  
(12 x 45)

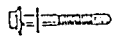

Tek Screw (Wall)  
With Neo Washer  
(10 x 16)



3-Break Ridge

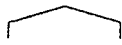

Roll Top Ridge



Slotted Fascia Gutter

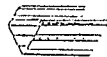

Fascia Gutter Stop  
End



Fascia Gutter  
Concealed Bracket



Fascia Capping



Slotted Quad Gutter



Fly Brace

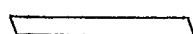

Quad Gutter  
Stop Ends



Quad Gutter  
Concealed Bracket



Domestic Header



PA Door Header



PA Door Jamb



PA Brace Angle



PA Lock Rail



PA Door Frame



PA Door Hinge

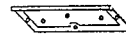

PA Cabin Hook



PA Door Lock



PA Door Handle



Window Flashing



Rad Flashing



Roller Door Jamb  
Flashing



Cyclone Pin Bracket



Cyclone Pin (with  
Fencing Chain)



Brace Tensioner  
with Bracing Strap

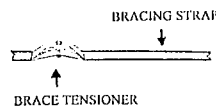

Fascia Splice Plate  
(Joiner)



Eave Purlin Bracket



Corner Plate



Angle Connector



Converter Beam  
Base Plate

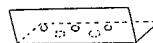

Front Mullion  
Bracket



M Pattern Barge  
Capping



Domestic Truss  
Splice Plate



Industrial Truss  
Splice Plate



Angle Plate



Footing Bracket



"Z" Section



"C" Section



Window Jamb



Awning Splice  
Plate



Apex Plate



Knee Plate



Fascia Splice  
Plate



Brace Angle



Gutter Support  
Bracket



Trim Angle



Eave Purlin



Front Mullion  
Cap



Window



Roller Door



Roller Door  
Header Flashing



Machinery Flashing



Awning Flashing



Corner Flashing



PICTURES ARE NOT TO SCALE